

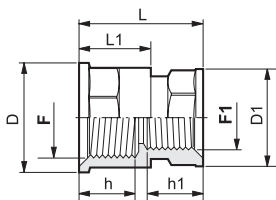

Riduzione Femmina / Femmina
Female / Female reducer nipple
Reduccion Hembra / Hembra



COD. CODE Cód.	F (BSP)	F1 (BSP)	h (mm)	h1 (mm)	L (mm)	L1 (mm)	D (mm)	D1 (mm)	
235 2010	G 3/8	G 1/4	18	14	35	23	27	21	25
235 2020	G 1/2	G 1/4	19	14	37.5	25.5	32	21	25
235 2021	G 1/2	G 3/8	19	17	40.5	25.5	32	27	25
235 2031	G 3/4	G 3/8	23	17	44.5	29.5	40	27	25
235 2032	G 3/4	G 1/2	23	19	47	29.5	40	32	25
235 2042	G 1	G 1/2	23	19	47	29.5	45	32	25
235 2043	G 1	G 3/4	23	23	51	29.5	45	40	25
235 2053	G 1 1/4	G 3/4	25	23	53	32	56	40	25
235 2054	G 1 1/4	G 1	25	23	53	32	56	45	25
235 2064	G 1 1/2	G 1	25	23	53	32	62	45	10
235 2065	G 1 1/2	G 1 1/4	25	25	55	32	62	56	10
235 2075	G 2	G 1 1/4	28	25	58	35	76	56	10
235 2076	G 2	G 1 1/2	28	25	58	35	76	62	10



Riduzione Maschio / Femmina
Male / Female reducer nipple
Reduccion Macho / Hembra

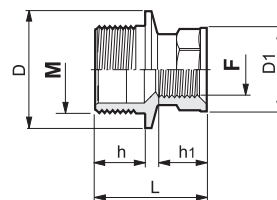

COD. CODE Cód.	M (BSP)	F (BSP)	h (mm)	h1 (mm)	L (mm)	D (mm)	D1 (mm)	
245 010	G 3/8	G 1/4	13	10	23	22	22	25
245 2032	G 3/4	G 1/2	22	19	47.5	40	32	25
245 2042	G 1	G 1/2	22	19	47.5	45	32	25
245 2043	G 1	G 3/4	22	23	51.5	45	40	25
245 2053	G 1 1/4	G 3/4	24	23	53.5	56	40	25
245 2054	G 1 1/4	G 1	24	23	53.5	56	45	25
245 2064	G 1 1/2	G 1	24	23	53.5	62	45	10
245 2065	G 1 1/2	G 1 1/4	24	25	56	62	56	10
245 2075	G 2	G 1 1/4	27	25	59	76	56	10
245 2076	G 2	G 1 1/2	27	25	59	76	62	10
245 2097	G 3	G 2	35	28	72.5	106	76	10



Manicotto Maschio / Femmina
Male / Female threaded coupling
Manguito Macho / Hembra

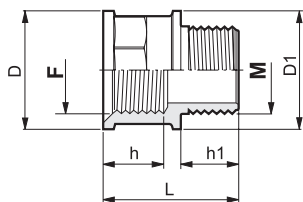

COD. CODE Cód.	M (BSP)	F (BSP)	h (mm)	h1 (mm)	L (mm)	D (mm)	D1 (mm)	
245 2022	G 1/2	G 1/2	19	18	43.5	32	32	25
245 2033	G 3/4	G 3/4	23	22	51.5	40	40	25
245 2044	G 1	G 1	23	22	51.5	45	45	25
245 2055	G 1 1/4	G 1 1/4	25	24	56	56	56	25
245 2066	G 1 1/2	G 1 1/2	25	24	56	62	62	10
245 2077	G 2	G 2	28	27	62	76	76	10



Riduzione Femmina / Maschio
Female / Male reducer nipple
Reduccion Hembra / Macho

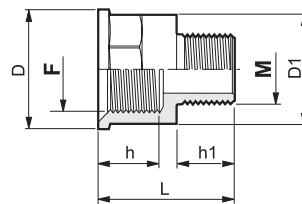

COD. CODE Cód.	F (BSP)	M (BSP)	h (mm)	h1 (mm)	L (mm)	D (mm)	D1 (mm)	
245 2001	G 3/8	G 1/4	17	11	36	27	22	25
245 2002	G 1/2	G 1/4	19	13	38.5	32	21	25
245 2012	G 1/2	G 3/8	19	16	41.5	32	27	25
245 2013	G 3/4	G 3/8	23	16	45.5	40	27	25
245 2023	G 3/4	G 1/2	23	18	47.5	40	32	25
245 2024	G 1	G 1/2	23	18	47.5	45	32	25
245 2034	G 1	G 3/4	23	22	51.5	45	40	25
245 2035	G 1 1/4	G 3/4	25	22	54	56	40	25
245 2045	G 1 1/4	G 1	25	22	54	56	45	25
245 2046	G 1 1/2	G 1	25	22	54	62	45	10
245 2056	G 1 1/2	G 1 1/4	25	24	56	62	56	10
245 2057	G 2	G 1 1/4	28	24	59	76	56	10
245 2067	G 2	G 1 1/2	28	24	59	76	62	10
245 2079	G 3	G 2	27	25	60	106	106	10