

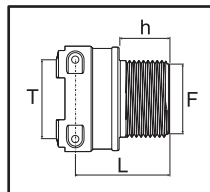

RACCORDI CON ATTACCO A FORCHETTA
FITTINGS WITH FORK COUPLING
RACORES CON CONEXION DE HORQUILLA

Raccordo filettato maschio attacco femmina
 Male threaded with female connection
 Rosca macho con conexión hembra



COD. CODE CÓD.	T	F	L (mm)	h (mm)		COD. CODE CÓD.
249 033	T3	G 3/4 M	40	22	25	010003
249 044	T4	G 1 M	41	22	25	010004
249 055	T5	G 1 1/4 M	46	24	10	010005
249 064	T6	G 1 M	46	22	10	010006
249 065		G 1 1/4 M	48	24	10	
249 066		G 1 1/2 M	49	24	10	
249 067		G 2 M	47	27	10	
249 076	T7	G 1 1/2 M	53	24	10	010007
249 077		G 2 M	59	27	10	

Raccordo filettato maschio attacco maschio
 Male threaded with male connection
 Rosca macho con conexión macho

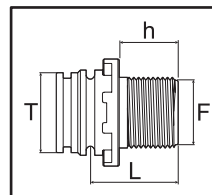

COD. CODE CÓD.	T	F	L (mm)	h (mm)		O'ring	
						COD. (EPDM)	COD. (Viton®)
249 133	T3	G 3/4 M	33	22	25	G11058	G11058V
249 144	T4	G 1 M	33	22	25	G11054	G11054V
249 155	T5	G 1 1/4 M	37	24	10	G11063	G11063V
249 166	T6	G 1 1/2 M	42	24	10	G11023	G11023V
249 177	T7	G 2 M	45	27	10	G11017x2	G11017Vx2
249 199	T9	G 3 M	54	35	5	G11067x2	G11067Vx2

Raccordo passaparete filettato maschio attacco maschio
 Bulkhead male threaded with male connection
 Pasapared rosca macho con conexión macho

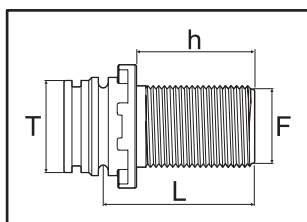

COD. CODE CÓD.	T	F	L (mm)	h (mm)		O'ring	
						COD. (EPDM)	COD. (Viton®)
249 1551	T5	G 1 1/4 M	68	55	10	G11063	G11063V
249 1661	T6	G 1 1/2 M	68	50	10	G11023	G11023V
249 1771	T7	G 2	68	50	10	G11017 x2	G11017V x2

Manicotto femmina / femmina
 Female / female coupling
 Manguito hembra / hembra

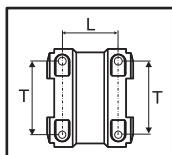

COD. CODE CÓD.	T	L (mm)		COD. CODE CÓD.
259 044	T4	30	25	010004
259 055	T5	32	10	010005
259 066	T6	41	10	010006
259 077	T7	47	10	010007
259 099	T9	54	5	010009

Nipplo maschio / maschio
 Male / male nipple
 Unión macho / macho

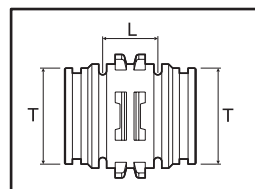

COD. CODE CÓD.	T	L (mm)		O'ring	
				COD. (EPDM)	COD. (Viton®)
259 133	T3	17	25	G11058	G11058V
259 144	T4	19	25	G11054	G11054V
259 155	T5	20	10	G11063	G11063V
259 166	T6	28	10	G11023	G11023V
259 177	T7	28	10	G11017 x2	G11017V x2
259 199	T9	31	5	G11067 x2	G11067V x2