

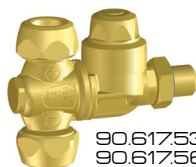

M90



**POSIZIONAMENTO
E TENUTA SENZA COLLANTI**
**ADJUST NOZZLE POSITION
AND SEAL WITHOUT BONDING**



90.617.53
90.617.56

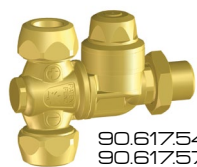

90.617.54
90.617.57

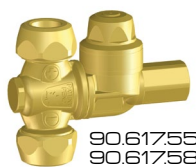

90.617.55
90.617.58



G1/4M-1/4" BSPM
Dado con O Ring
Nut with O Ring

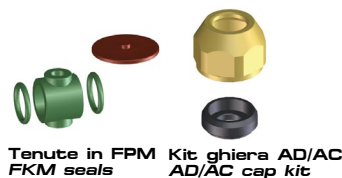
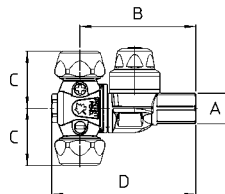
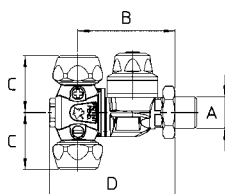
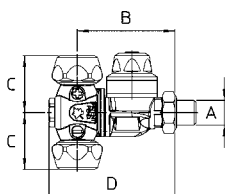

Tenute in FPM
FKM seals

Kit ghiera AD/AC
AD/AC cap kit

Standard completi di ghiera. Ugelli non compresi
Ghiera per ugelli: Kit Ø15, Kit Ø18, ALBUZ® ATR/TVI, ALBUZ® AD/AC

Versioni con attacco G1/4M.: standard dado G1/4F. con O Ring FPM

Versioni con attacco G3/8M. - G1/8F.: standard completi di dado

Pressione di esercizio max.: 40 bar

Peso: G1/4M. 255 g - G3/8M. 270 g - G1/4F. 255 g

Materiali: ottone - acciaio inox - FPM

Impiego: su atomizzatori. Due ugelli selezionabili con posizione intermedia di chiusura. Ingombri ridotti. Due posizioni di spruzzo inclinate di 20°. Posizioni segnalate da uno scatto. Antigoccia resistente ed efficace in un ampio range di pressioni. Dimensioni di passaggio del fluido ampliate per ridurre le perdite di carico e per migliorare la durata. Resistenza chimica migliorata con l'impiego di tenute in FPM. Versioni con attacco G1/4M. forniti con dado e O Ring per il montaggio orientato del getto sui collettori senza utilizzare collanti.

Standard with caps. Spray tips not included

Available caps for: Ø15 kit, Ø18 kit, ATR/TVI ALBUZ®, AD/AC ALBUZ® spray tips

1/4" BSPM. models: standard with 1/4" BSPF. nut and FKM O Ring

3/8" BSPM. - 1/8" BSPF. models: standard complete with nut

Max. operating pressure: 40 bar / 580 psi

Weight: 1/4" BSPM. 255 g / 9 oz - 3/8" BSPM. 270 g / 9.5 oz - 1/4" BSPF. 255 g / 9 oz

Materials: brass - stainless steel - FKM

Use: on air blast sprayers. Very compact rollover to select spray tips with two shut off positions. Two "OPEN" positions at ±20° from vertical. A click point out each position. Check valve assures efficient and long lasting operations at low and high pressures. Low pressure drops. Improved chemical resistance with FKM seals. 1/4" BSPM. boom connection models with nut and O Ring to adjust nozzle position on booms without bonding.

COME SI ORDINA / HOW TO ORDER

CODICE code	GHIERA cap	PER UGELLI for spray tips	A	B mm	C mm	D mm		KIT RICAMBIO spare parts kit						
90.617.53	2xØ18	Ø18 kit	G1/4M. 1/4" BSPM.	51	30	66	10	90.302.59						
90.617.53A	1xØ18-1xØ15	Ø18 kit-ATR/TVI												
90.617.53B	2xØ15	ATR/TVI												
90.617.53D	2xAD/AC	AD/AC												
90.617.53E	1xAD/AC-1xØ18	AD/AC-Ø18 kit	G3/8M-G1/8F. 3/8" BSPM.-1/8" BSPF.	51	30	66	10	90.302.59						
90.617.53F	1xAD/AC-1xØ15	AD/AC-ATR/TVI												
90.617.54A	1xØ18-1xØ15	Ø18 kit-ATR/TVI												
90.617.54B	2xØ15	ATR/TVI												
90.617.54D	2xAD/AC	AD/AC	G1/4F. 1/4" BSPF.	62	30	76	10	90.302.59						
90.617.54E	1xAD/AC-1xØ18	AD/AC-Ø18 kit												
90.617.54F	1xAD/AC-1xØ15	AD/AC-ATR/TVI												
90.617.55	2xØ18	Ø18 kit							G1/4M. 1/4" BSPM.	51	30	66	10	90.302.59
90.617.55A	1xØ18-1xØ15	Ø18 kit-ATR/TVI												
90.617.55B	2xØ15	ATR/TVI												
90.617.55D	2xAD/AC	AD/AC												
90.617.55E	1xAD/AC-1xØ18	AD/AC-Ø18 kit	G3/8M-G1/8F. 3/8" BSPM.-1/8" BSPF.	51	30	66	10	90.302.59						
90.617.55F	1xAD/AC-1xØ15	AD/AC-ATR/TVI												
90.617.56	2xØ15	Ø15 kit-ATR/TVI							G1/4F. 1/4" BSPF.	62	30	76	10	90.302.59
90.617.56D	2xAD/AC	AD/AC												
90.617.56E	1xAD/AC-1xØ15	AD/AC-Ø15 kit-ATR/TVI												
90.617.57	2xØ15	Ø15 kit-ATR/TVI	G1/4M. 1/4" BSPM.	51	30	66	10	90.302.59						
90.617.57D	2xAD/AC	AD/AC												
90.617.57E	1xAD/AC-1xØ15	AD/AC-Ø15 kit-ATR/TVI												
90.617.58	2xØ15	Ø15 kit-ATR/TVI							G3/8M-G1/8F. 3/8" BSPM.-1/8" BSPF.	51	30	66	10	90.302.59
90.617.58D	2xAD/AC	AD/AC												
90.617.58E	1xAD/AC-1xØ15	AD/AC-Ø15 kit-ATR/TVI												



**UGELLI
TIPS**