



# M65



POSIZIONAMENTO  
E TENUTA SENZA COLLANTI  
ADJUST NOZZLE POSITION  
AND SEAL WITHOUT BONDING



G1/4M.-1/4" BSPM  
Dado con O Ring  
Nut with O Ring

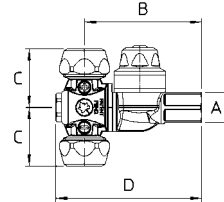
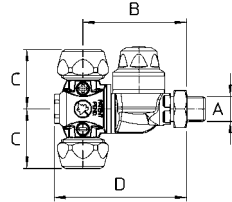
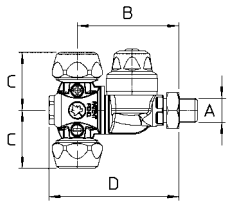

Kit ghiera AD/AC  
AD/AC cap kit

**Standard completi di ghiera. Ugelli non compresi**  
Ghiere per ugelli: Kit Ø15, Kit Ø18, ALBUZ® ATR/TVI, ALBUZ® AD/AC, LECHLER TR  
Versioni con attacco G1/4M.: standard dado G1/4F. con O Ring NBR  
Versioni con attacco G3/8M. - G1/8F.: standard completi di dado

Pressione di esercizio max.: 40 bar  
Peso: G1/4M. 240 g - G3/8M. 260 g - G1/4F. 230 g  
Materiali: ottone - acciaio inox - NBR - PVC

**Impiego:** su atomizzatori. Due ugelli selezionabili con posizione intermedia di chiusura. Ingombri ridotti. Due posizioni di spruzzo inclinate di 20°. Posizioni segnalate da uno scatto. Antigoccia resistente ed efficace in un ampio range di pressioni. Dimensioni di passaggio del fluido ampliate per ridurre le perdite di carico e per migliorare la durata. Versioni con attacco G1/4M. forniti con dado e O Ring per il montaggio orientato del getto sui collettori senza utilizzare collanti.

**Standard with caps. Spray tips not included**  
Available caps for : Ø15 kit, Ø18 kit, ATR/TVI ALBUZ®, AD/AC ALBUZ®, LECHLER TR spray tips  
1/4" BSPM. models: standard with 1/4" BSPF. nut and Buna N O Ring  
3/8" BSPM. - 1/8" BSPF. models: standard complete with nut

Max. operating pressure: 40 bar / 580 psi  
Weight: 1/4" BSPM. 240 g / 8.5 oz - 3/8" BSPM. 260 g / 9 oz - 1/4" BSPF. 230 g / 8 oz  
Materials: brass - stainless steel - Buna N - PVC

**Use:** on air blast sprayers. Very compact rollover to select spray tips with two shut off positions. Two "OPEN" positions at ±20° from vertical. A click point out each position. Check valve assures efficient and long lasting operations at low and high pressures. Low pressure drops. 1/4" BSPM. boom connection models with nut and O Ring to adjust nozzle position on booms without bonding.

## COME SI ORDINA / HOW TO ORDER

| CODICE<br>code   | GHIERA<br>cap  | PER UGELLI<br>for spray tips   | A                                      | B<br>mm | C<br>mm | D<br>mm |  | KIT<br>RICAMBIO<br>spare parts kit |
|--|--|--|--|---------|---------|---------|---|------------------------------------|
| 65.627.1<br>65.627.1 A<br>65.627.1 B<br>65.627.1 D<br>65.627.1 E<br>65.627.1 F | 2xØ18<br>1xØ18-1xØ15<br>2xØ15<br>2xAD/AC<br>1xAD/AC-1xØ18<br>1xAD/AC-1xØ15 | Ø18 kit<br>Ø18 kit-ATR/TVI<br>ATR/TVI<br>AD/AC<br>AD/AC-Ø18 kit<br>AD/AC-ATR/TVI | G1/4M.<br>1/4" BSPM.                   | 54      | 31      | 69      | 10  | 75.302.28                          |
| 65.627.2<br>65.627.2 A<br>65.627.2 B<br>65.627.2 D<br>65.627.2 E<br>65.627.2 F | 2xØ18<br>1xØ18-1xØ15<br>2xØ15<br>2xAD/AC<br>1xAD/AC-1xØ18<br>1xAD/AC-1xØ15 | Ø18 kit<br>Ø18 kit-ATR/TVI<br>ATR/TVI<br>AD/AC<br>AD/AC-Ø18 kit<br>AD/AC-ATR/TVI | G3/8M.-G1/8F.<br>3/8" BSPM.-1/8" BSPF. | 54      | 31      | 69      | 10  | 75.302.28                          |
| 65.627.3<br>65.627.3 A<br>65.627.3 B<br>65.627.3 D<br>65.627.3 E<br>65.627.3 F | 2xØ18<br>1xØ18-1xØ15<br>2xØ15<br>2xAD/AC<br>1xAD/AC-1xØ18<br>1xAD/AC-1xØ15 | Ø18 kit<br>Ø18 kit-ATR/TVI<br>ATR/TVI<br>AD/AC<br>AD/AC-Ø18 kit<br>AD/AC-ATR/TVI | G1/4F.<br>1/4" BSPF.                   | 62      | 31      | 77      | 10  | 75.302.28                          |
| 65.627.4<br>65.627.4 D<br>65.627.4 E<br>65.627.4 I                             | 2xØ15<br>2xAD/AC<br>1xAD/AC-1xØ15<br>2Xkit TR                              | Ø15 kit-ATR/TVI<br>AD/AC<br>AD/AC-Ø15 kit-ATR/TVI<br>TR LECHLER                  | G1/4M.<br>1/4" BSPM.                   | 54      | 31      | 69      | 10  | 75.302.28                          |
| 65.627.5<br>65.627.5 D<br>65.627.5 E   | 2xØ15<br>2xAD/AC<br>1xAD/AC-1xØ15  | Ø15 kit-ATR/TVI<br>AD/AC<br>AD/AC-Ø15 kit-ATR/TVI                                | G3/8M.-G1/8F.<br>3/8" BSPM.-1/8" BSPF. | 54      | 31      | 69      | 10  | 75.302.28                          |



UGELLI  
TIPS